

Of course, today less than car load shipments usually go by truck and personal things are delivered right to your door. However, in their day, the freighthouses served as a necessary part of the railroad and could be found near the freight yard or even in the heart of the town that it served.

Decide upon a color scheme for your railroad if you haven't one already and paint the window, door, and roof support castings before assembly. Also, all angle corner trim, $1\frac{1}{32}$ " x $\frac{3}{32}$ " stripwood (trim) and $\frac{3}{32}$ " sq. and $1\frac{1}{16}$ " x $\frac{3}{32}$ " (fancy work). This will save you a lot of trouble later on. Yellow or cream and brown, dark green and light grey and maroon and grey are good combinations if you cannot think of any.

When thoroughly dry, turn it over and glue precut 3/16" stringers to the underside of the platform as shown: Leave a 1/16" overhang all the way around except where marked. Flush at the platform offset.

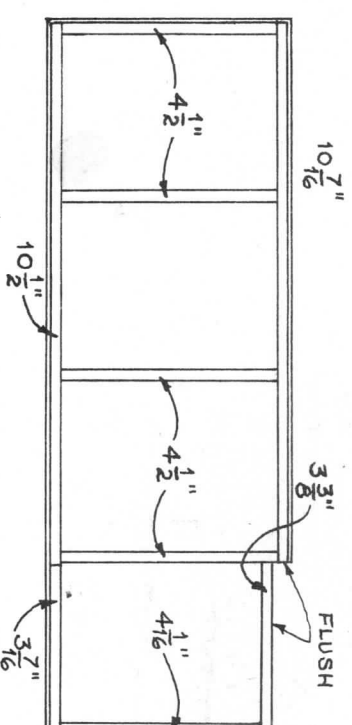

Diagram illustrating the mechanical structure of a platform scale, showing a cross-section of the weighing mechanism. The diagram includes a platform, a vertical column, and a horizontal beam with weights. Dimensions are indicated: 1" x 1" for the beam, 1/2" for the column, and 1" for the beam length. A 1/2" dimension is also shown for the column height.

STEP TEMPLATE



Now paint the remainder of the 1/32" x 1/8" stripwood your trim color.

2. BUILDING - Using wax paper to prevent the parts from sticking to your work surface glue both 15/16" x 3 1/2" clapboard siding pieces to the 3 1/2" sq. pieces to complete the roof peaks to your building ends. Be sure

SIDE

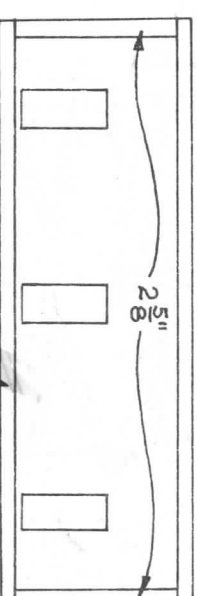

END

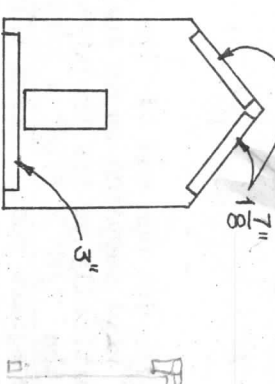

Glue the cast windows and door in place. Cut eight pieces $7/16"$ x $9/16"$ from the clear plastic supplied. Fit and glue these pieces into the double hung windows. A piece $3/4"$ x $1"$ will cover the window openings in the door.

On the inside of the side and end walls glue precut $3/16"$ sq. strips as shown. Flush with the edges to reinforce the walls. Notice

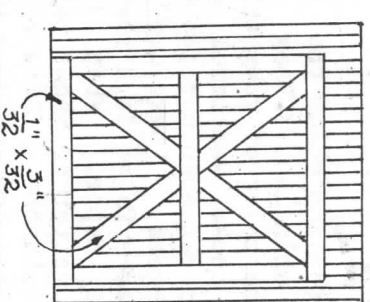

Fit, cut and glue $1/32"$ x $3/32"$ prepainted stripwood around the freight door openings and around the top edge of the building. Do the same around the bottom edges using $1/32"$ x $1/8"$ stripwood. Fit $1/8"$ prepainted angle strips to the four corners and glue them in place.

Cut two 1 $\frac{3}{8}$ " lengths of $\frac{3}{32}$ " sq. strip-wood and glue these flush with and below the angle lines on the end wall with the two doors. These strips will provide a support for the smaller platform roof.

ROOF AND FANCY WORK - Butt the two edges of the $3\frac{1}{2}$ " x $8\frac{1}{4}$ " pieces of card stock together lengthwise to form the large roof. Using a strip of Scotch or masking tape, join the

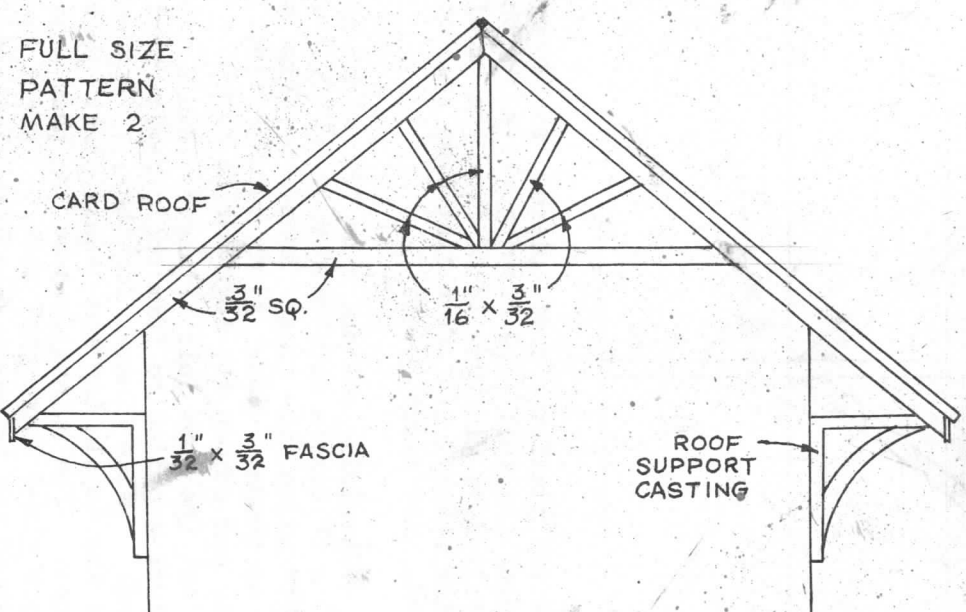

two together. Do this with the two $1\frac{1}{2}$ " x $6\frac{1}{4}$ " pieces to form the platform roof. Now glue the large card roof to the freighthouse, centering the overhang on both sides and ends.

Next, glue the cast roof supports to the side of the building at each corner and up against the roof eave. They should fit behind the fascia board. Glue seven across each side at equidistant spacing.

Diagram of a square roof truss structure. The truss is labeled "SERN 2" and "SIZE". The dimensions are given as $\frac{3}{2}$ " SQ. for the top section and $\frac{1}{2}$ " x $\frac{3}{2}$ " for the bottom section. The truss is supported by a horizontal line at the bottom.

CUPOLA - Carefully cut out the "V" notch on both $\frac{1}{2}$ " x 1" cupola cardboard ends. Glue the $\frac{1}{2}$ " x $7/8$ " sides to these ends to form a square as shown. Then glue cupola floor, louvers, and cupola top together as shown.

Paint the louvers the same color as the building walls. Then cut four pieces of 1/8" angle trim and glue these over the four corners of the louvers. The rest of the cupola is painted your trim color.

CHIMNEY - Cut one end of the 3/16" x 5/16" x 1 1/8" wood supplied on an angle so it will sit vertically on the freighthouse roof. Now glue the 1/8" x 5/16" x 7/16" chimney top to the square end. Paint this cement color. Cover the rest of the chimney with brick paper supplied. Glue the chimney to the roof about 1/2" in from the roof edge directly above the area between the door and freight door. Finally, glue the building to the freight platform as shown in the sketch leaving a 1/16" edge showing along the platform.

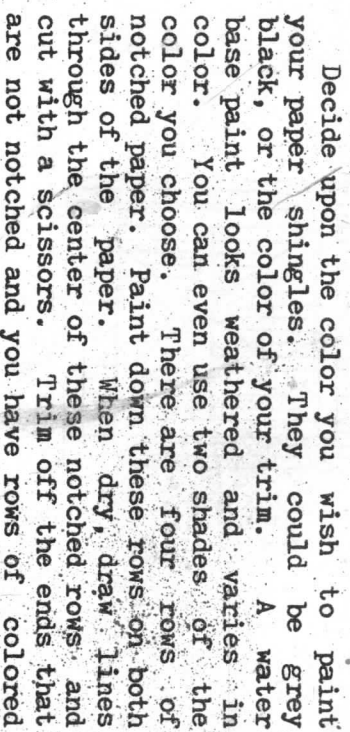

peak, cut a $\frac{1}{4}$ " strip of paper and fold it lengthwise down the center. Glue this over the peak as the cap strip. Paint it to match the rest of the shingles.

LIGHTS - Cut, bend, then glue or solder the wire provided to form the lamp shades as shown:

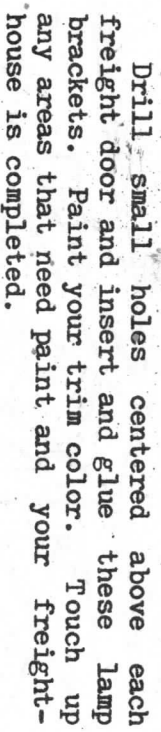

Boxes, crates, bags, pallets and all sort of items should be stacked upon the platform to provide that busy look. Of course people are necessary to complete the scene as well as autos, a horse and wagon if you prefer, or an old truck will help. We hope you have enjoyed assembling our freighthouse and hope you will try some of our other kits as well.

LVM1.....	Branchline Station
LVM2.....	50,000 Gallon Water Tank
LVM3.....	100 Ton Coaling Station
LVM4.....	Cantry Crane
LVM5.....	Crossing Gate
LVM6.....	Electric Utility Pole Kit
LVM7.....	Continental Canning Company
LVM8-C.....	Mack Coal Delivery Truck
LVM8-L.....	Mack Lumber Truck
LVM8-T.....	Mack Fuel Oil Truck
LVM9.....	Heavy Duty Track Bumper
LVM10.....	Reading 2-8-0 Locomotive Kit
LVM11.....	Water Column
LVM12.....	Diesel Steam Loco or Car Shop
LVM13.....	Track End Car Stops
LVM14.....	Coal Breaker
LVM15.....	Minehead
LVM16.....	Powerhouse
LVM17.....	J. Harry Jones Coal Company
LVM18.....	Freighthouse

Send \$1.00 for a photographically illustrated catalog of these products.

LVM18
FREIGHTHOUSE

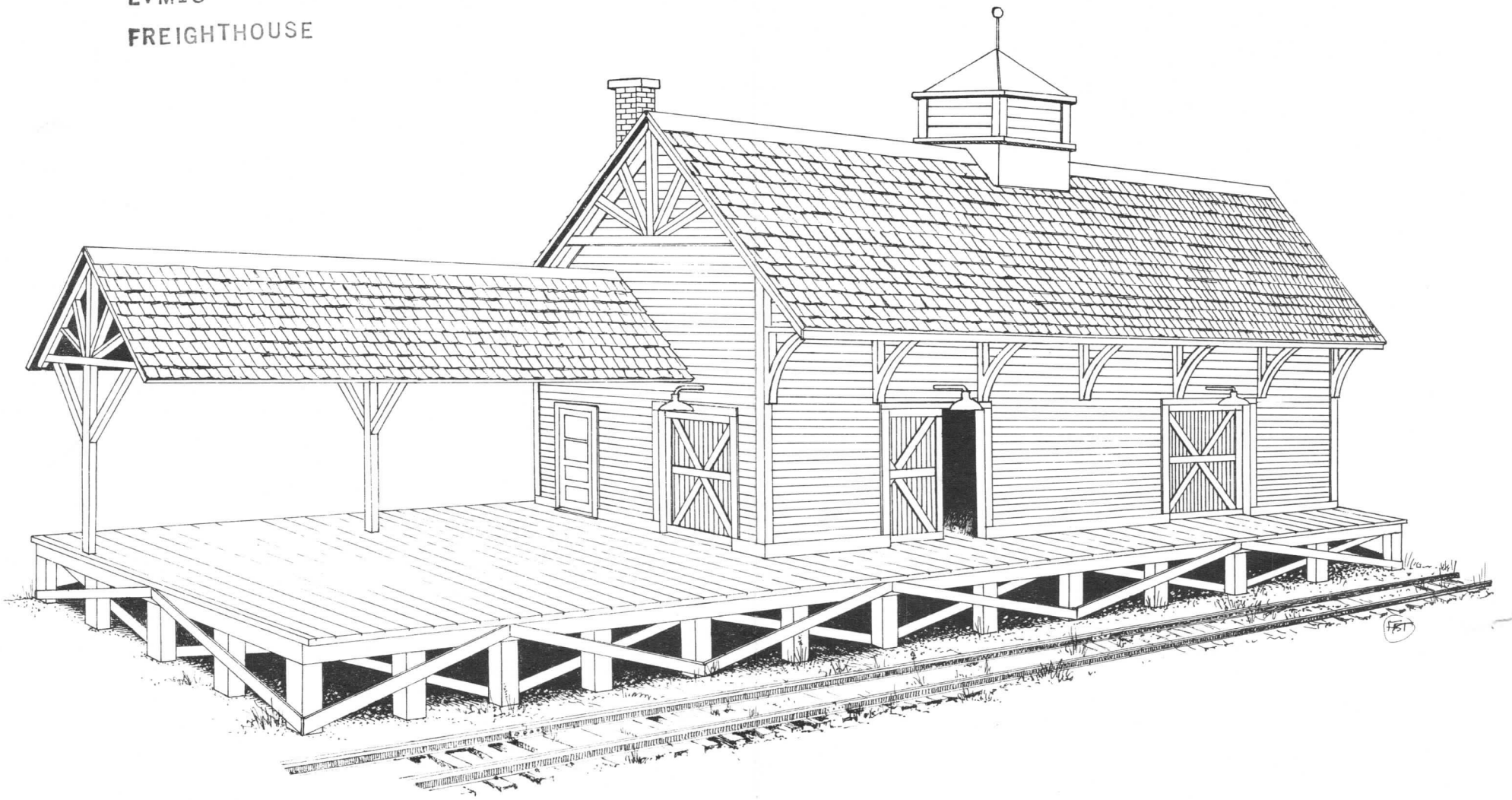

Property of
NASC Inc.

