

Bank/Storefront

This interesting structure, while named a bank, can serve as practically any kind of store. The design is classic just after the turn of the century. It may look "modern", however, the design is about 100 years old! As with any of our kits, please read through the instructions and study the drawings before starting any assembly to familiarize yourself with the construction.

This kit is designed to fit a slope, but can be made without the basement, if you wish. We feel the slope adds greatly to the overall appeal and should be retained if at all possible.

1. Let's begin construction by lightly sanding the Hydrocal casting backs to smooth them up. Carefully remove any flash from the edges. The resin parts can be trimmed from the "flat" they are cast in. The upper cornice pieces will need trimming to fit later. Trim the door and window castings also at this time.

2. Now it is time to paint the walls. We use Apple Barrel acrylics sold in Michael's and even WalMart. They are rather inexpensive and work well as washes. Also, other brands work as well and will intermix. We used Burnt Umber with a little Black for the stone walls. A very thin wash was made. This was mostly water with a little pigment. Keep your washes light. Successive coats will build up the tone. Don't start too dark! We slopped the stain over all on the stone walls. Next, we added another drop of brown and stained again. Try to work wet on wet so everything "blends" better. We did this several times until we were satisfied with the darkness. We then used artist's Gesso for mortar. Just paint on a small patch over the stones and then wipe it off with a clean, soft cloth. This will remove most Gesso from the surface of the stones, but will leave "mortar" in the joints. The little that is left on the stones will act to tone them down and tie everything together.

The bricks are a little more complex. We used about four different "Reds" as well as Black. Brick Red, Barn Red, Red Clay and a slightly pinker mix. First step is to paint the wall with a base coat of Barn Red. This can be thinned a little to help cover, but all of the colors on the bricks should be pretty much "from the bottle". Now that a base coat has been applied overall, the fun begins. We used another red and painted about 5% of all the bricks with it. When finished, pick another red and repeat the process. You can finish up with Black, but only do a few bricks here and there. That's that. Now for the mortar. This is just like you did for the stones. Work in a small area at a time and don't go over an area that has been done already -- you'll remove some brick color!!

Now for the sidewalks. For this we used very thin stains of brown with a little Antique White added. This thin mix was slopped on overall and before it dried, more was applied. Wet on wet. Build up to the tone you like. Now use a pointed brush and darker brown stain. Wet the walk a little and touch the loaded brush to a crack. Capillary action will fill the wet crack with nice brown stain! Repeat until you are finished.

The door and window castings and laser work were pre-painted a green. The lower storefront walls were painted two tone green. The cornice was painted Antique White. These pieces will need to be trimmed later, so touch up will be necessary. The door to



the basement was painted a dark brown undercoat. Then, Dr. Ben's World Famous Rust was used to give the door a really disgusting finish. Beautiful!

3. The base. We used a small piece of cabinet grade plywood as a base. To this we glued pieces of styrofoam. When dry, we carved the slope and fabricated a street. We recessed the sidewalk and steps down the side. No finish was applied to this base until the structure was all glued in place.

4. We started with the basement walls. A box was fashioned out of the four walls. Work on a flat surface and keep things square. Notice, there is a lip all around the inside top of the walls. This is to recess a card floor into. Add the floor now. Cut it from the card supplied.

The first story is a little more complex. Some fitting and filing will be necessary. We began with the long side wall and the rear. Glue these in place atop the basement walls. It is a good idea to do a dry run before you start glueing just to see how things fit. Next, add the shorter side wall. Add the front and check to make sure the little upper wall fits. A little filing will be necessary. Do not add this last piece at this time. Let this set. Keep things square and level. Add the 1/8" square wood roof bracing around the inner edges as shown by the dashed line in the drawings. Paint the interior black (unless you plan on detailing it). You can add the walks and steps at this time. Don't forget the two rails that go at either side of the basement door. Fashion these from the wire supplied. We painted ours a worn silver with some rust showing.

5. The storefront is next. Glaze the two laser window panels with your favorite material. Glaze the front doors and rear window. Glue the lower storefront walls in place. Line up the stops for the windows with those on the walls. Fasten the styrene tubes at either side of the door casting. Then push this unit in from the top and rear until it fits up against the big windows. There is a notch in the lower walls for this tube. Then you can glue the upper brick wall section in place. The cornice can be added. You'll need to trim here also. A little extra was designed into this kit because each kit will be assembled slightly differently, and this will "pick up the slack" in each kit. Add the triangle which represents cast iron in front of the doorway. Paint silver and rust.

6. Cut the roofing and glue in place. Add your favorite roofing material. We used tissue as roofing paper (tar paper). Start at the lower edge (rear) and work your way up to the front. We used white glue for this. Add the stack. Touch up paint or fill some cracks with spackling paste if need be. Weather. Have fun detailing the rear. Grow some vines up the wall. Add a bunch of junk and trash around and work into your scenery. This little structure will make a nice addition to your growing town area. If you did not use the basement on this model, you can use this element elsewhere as a basement with a burned out first floor. Add floor joists - falling into the basement - which is full of debris and junk. Add fallen in wall remnants and what is left of a roof and you'll have a very interesting detail for another area on your pike! Add a smoke unit and -- wow! What a nice detail.

FRONT ELEVATION

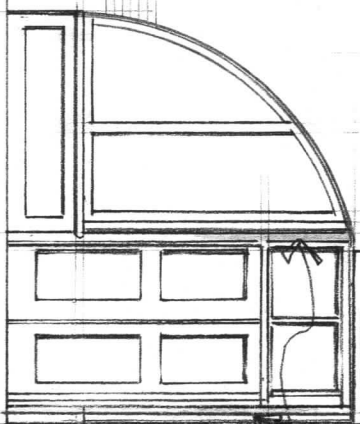

STYRENE TUBE
TOP VIEW of ROOF

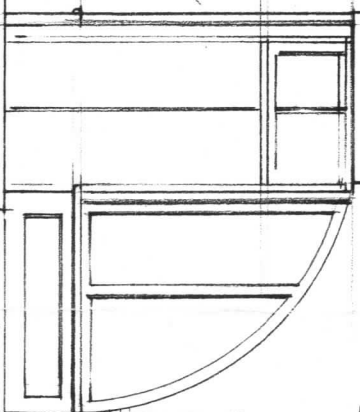

BRICK
1/8" WOOD

RIGHT ELEVATION

RAILINGS

© 2008 JAY

BRICK

STEPS 12 WIDE

RAILINGS (2)